



Mobile Lab Desk



MOBILE DOCUMENTATION DESK DESIGNED FOR LABS

Specialized lab teams need a documentation station that keeps paperwork organized and accessible without disrupting workflow. Traditional desks are bulky, difficult to move, and often lack the storage needed for fast-paced procedural environments. The TrippNT Mobile Lab Desk is constructed of chemical resistant, highly durable polypropylene and provides a compact, mobile workspace with organized storage and easy maneuverability for cath labs, and any other high acid, metal or water labs.

COMPACT WORKSTATION

- Slim footprint fits easily inside busy lab environments.

MOBILE DESIGN

- Smooth rolling casters allow effortless repositioning between work areas.

ERGONOMIC WORKFLOW

- Open knee space accommodates seated documentation comfortably.

LIFETIME GUARANTEE

- Work stress-free, knowing your cart is covered for life.

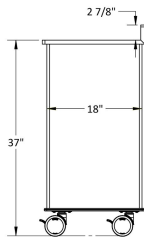
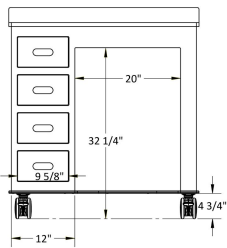
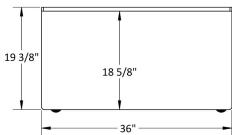

ASK ABOUT OUR DEMO PROGRAM
Try it out at your facility.



Storage

- Four drawers organize paperwork and essential supplies.



Seated Space

- Provides comfortable access for administrative tasks.



Twin-Wheel Casters

- Easily move over gaps and lock in place when work is being done.



Durable HDPE Work Surface

- Supports everyday work and equipment needs in demanding clinical settings.

