



Core DX Cart with Sliding Door & Railtop

Part No. 53504

TrippNT's Core DX Cart with Sliding Door, and Railtop organizes, stores, and secures supplies. It offers a 1-inch railtop for secure top storage, 3 drawers, 4 shelves, 2 dispensing shelves, and bulk storage with a sliding clear door. It's built-in handles are ergonomic and easy to grab. The sliding door offers a smaller usage footprint. It is constructed from a corrosion-resistant, non-metal polymer with robust 4-inch twin wheel casters capable of easily navigating elevator gaps and uneven surfaces. Available in 6 color variants.



53504



53516



53506



53505



53509



53589

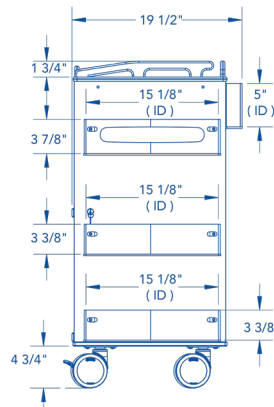
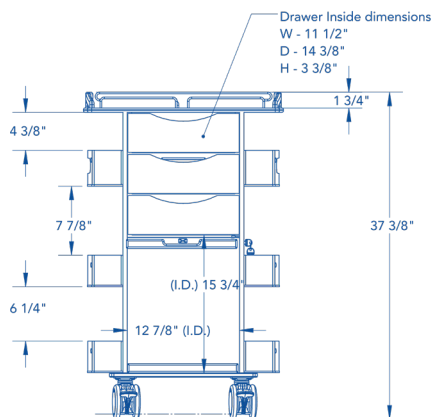
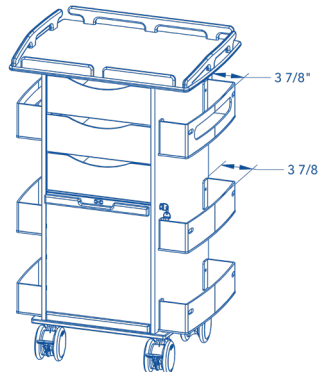
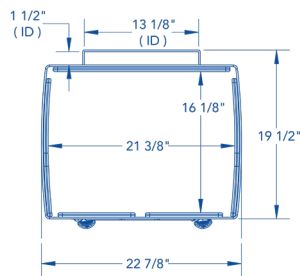

Features:

- 1 inch rail top, 2 Locking & 2 swivel 4 inch twin Wheel Casters, 3 Total Locking Drawers, 6 Side Shelves, Locking Bulk Storage with Sliding Drawer
- Built-in Easy to Grab Handles
- Corrosion-Resistant, Non-Metal HDPE Construction
- Organizes, Stores & Secures Supplies



Short Lead Times



Made in the U.S.A



Corrosion Resistant



100% Lifetime Guarantee

Rev: 53504.1-3