



Stainless Steel Dual Dispensing Paper Towel Holder

Part No. 51283

Access matters when every movement counts. This stainless steel dispenser allows towels to be loaded once and dispensed from either opening, keeping hands clean, stations efficient, and workflow uninterrupted.

11 X 6 ½ X 4 ¼ inches WHD



Features:

- Rectangular Design with Angled Slot for Bottom Dispensing and Open Top
- Mounts Easily to Wall with Provided Hardware
- Constructed from Stainless Steel
- Protects Paper Towels Keeping them Clean, Neat and Dry

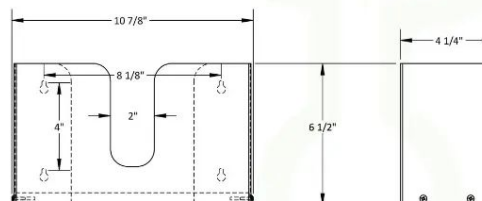
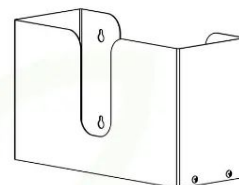
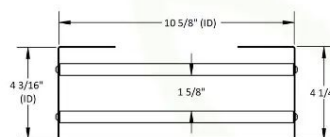

This item ships with 4 screws and anchors.



Corrosion Resistant



Short Lead Times



Ships Assembled



Made in the U.S.A



100% Lifetime Guarantee