



## Clear Large Tissue Box Holder

Part No. 51140

Clear, durable PETG tissue box holder keeps wipes visible, clean, and within reach. Wall mounts anywhere to declutter benches and support a compliant, efficient workspace—so your team stays focused on research, not restocking.

9 x  $\frac{5}{8}$  x 5  $\frac{1}{4}$  x 5  $\frac{3}{8}$  inches WHD



### Features:

- Made of clear, shatter-proof PETG so you can instantly see inventory status and avoid surprises
- Wall-mountable (horizontal or vertical) to free up bench or cart space in a busy shared lab
- Tension-design fits most popular 100-count facial-tissue brands

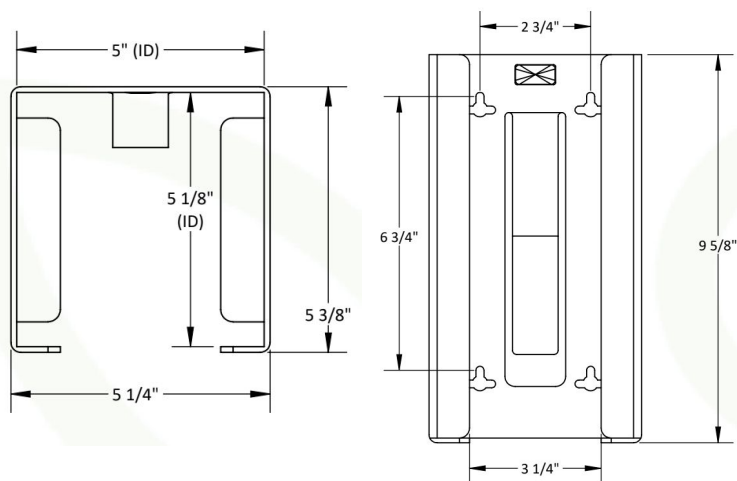

**Corrosion Resistant**



**Short Lead Times**



**Ships Assembled**



**Made in the U.S.A**



**100% Lifetime Guarantee**

