



# Procedure Cart Series



## Engineered for Urgency, Built for Reliability

In fast-paced clinical settings, the TrippNT 51046 Procedure Cart keeps anesthesia teams prepared with secure, clutter-free readiness. Six locking drawers, a recessed tray top, and smooth-gliding casters streamline organization and mobility. Built in the USA from non-metal HDPE, it arrives fully assembled—delivering dependable performance in tight, high-stakes clinical spaces.

## Hygienic & Durable

- Corrosion-resistant HDPE and ACP construction resists disinfectants and avoids rust, safeguarding equipment integrity

## Compact Yet Capacity-Rich

- Wide-push design packs space-saving storage for anesthesia kits without crowding tight OR corridors

## Secure, Mobile Readiness

- Six full-extension, key-locking drawers and 4-inch twin-wheel casters (2 locking, 2 swivel) keep instruments both organized and locked during transport.

## ASK ABOUT OUR DEMO PROGRAM

[Try it out at your facility.](#)

## LIFETIME GUARANTEE

- Work stress-free, knowing your cart is covered for life.



### Recessed Top

- Provides a stable, secure work surface



### Wide Drawers

- Fits up to two 11in trays in each drawer



### Two Drawer Depths

- Large capacity for a range of equipment



### Narrow Footprint

- 20" Depth enables use in tight spaces



10991 N Airworld Drive, Kansas City, MO, USA | 1 (800) 874-7768 | [Sales@TrippNT.com](mailto:Sales@TrippNT.com)

# Procedure Cart Series

## Streamlined Workflow

- Built-in recessed tray top with easy-grab handle gives clinicians quick-access staging for tools during procedures.

## Ready Out of the Box

- Ships fully assembled, eliminating setup delays and ensuring consistent, reliable quality from day one.

## Smooth Operation

- Balanced 88 lb. design and 4-inch casters glide quietly and steadily through crowded corridors without jostling supplies.

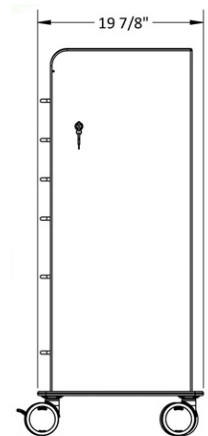
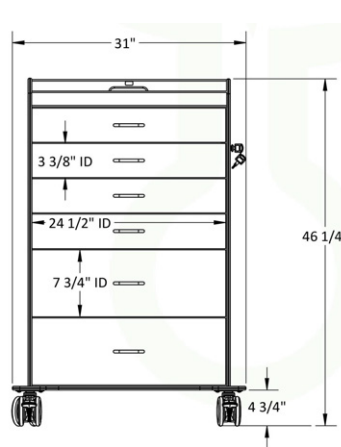
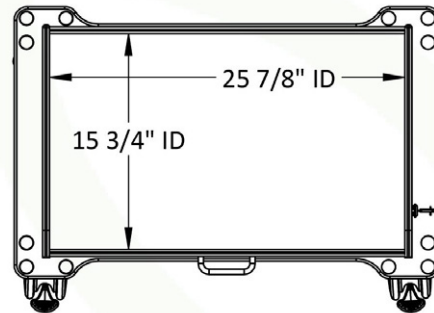

## COLOR OPTIONS



PN: 51046  
White



PN: 51078  
Almond Beige



PN: 51071  
Global Blue



PN: 51358  
Black



PN: 53593  
Dolphin Gray



PN: 51079  
Silver Metallic

## ACCESSORIES



PN: 50917  
4 Compartment



PN: 50974  
6 Compartment



PN: 50975  
4 Compartment



PN: 51998  
Adjustable

