



Single Tooth Glove Box Dispenser

Part No. 51053

Gloves shouldn't slow you down. The tooth-shaped dispensing cutouts make glove access intuitive and fast. This double dispenser keeps fresh boxes front and center so you restock easily, grab instantly, and keep every procedure flowing seamlessly.

10 ³/₄ X 5 ³/₈ X 3 ⁷/₈ inches WHD

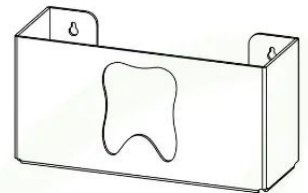
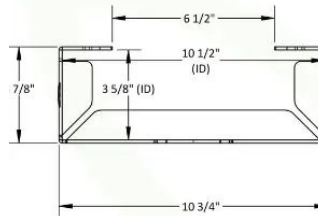

Features:

- Tooth Shaped Single Opening Glove Box Dispenser
- Mounts on Wall with Keyholes or Sits on Counter
- Constructed from White Styrene
- Holds and Dispenses Gloves Securely

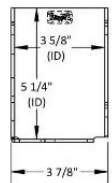
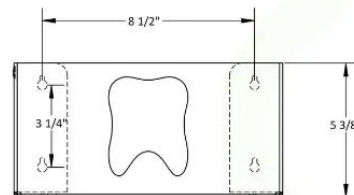

Corrosion Resistant



Short Lead Times



Ships Assembled



Made in the U.S.A



100% Lifetime Guarantee

