



## Pipette Storage 5 Bin Compartment

Part No. 50428

Streamline your pipette workflow with this angled, wall- or hood-mountable bin. With five open compartments and a sloped design, it keeps frequently used pipettes within reach while reducing contamination risk. Made from durable, cleanable PVC, this storage solution helps lab managers maintain order and efficiency in even the busiest workspaces.

4 ½ x 27 x 10 ½ inches WHD



### Features:

- **Angled for Visibility:** 5 sloped compartments allow for quick identification and grab-and-go access
- **Wall or Hood Mountable:** Keyholes on both sides help easily install where you need it most—no counter space required
- **Durable PVC Construction:** Resistant to chemicals, wear, and daily use
- **Efficient Workflow:** Keeps instruments upright, separated, and ready for action

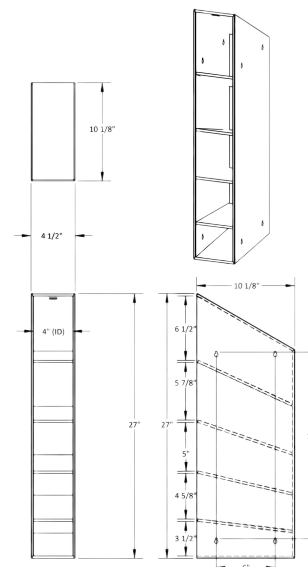

**Corrosion Resistant**



**Short Lead Times**



**Ships Assembled**



**Made in the U.S.A**



**100% Lifetime Guarantee**