



4-Compartment Clear Pipette Bin

Part No. 50112

Designed for busy lab benches and shared workstations, this clear acrylic pipette bin keeps up to four sets of pipettes upright, visible, and protected. Its angled compartments make grabbing and returning pipettes quick and easy—helping lab managers maintain order, improve access, and reduce contamination risk.

3 $\frac{5}{8}$ x 20 $\frac{5}{8}$ x 11 $\frac{1}{2}$ inches WHD

Features:

- **Ideal for Benchtops & Casework:**
Sits securely on flat surfaces or inside shelving
- **Clear Acrylic Construction:**
Durable, cleanable, and provides full visibility of contents
- **4 Angled Compartments:**
Securely separates pipettes or similar instruments

Watch the
Product Overview Video!

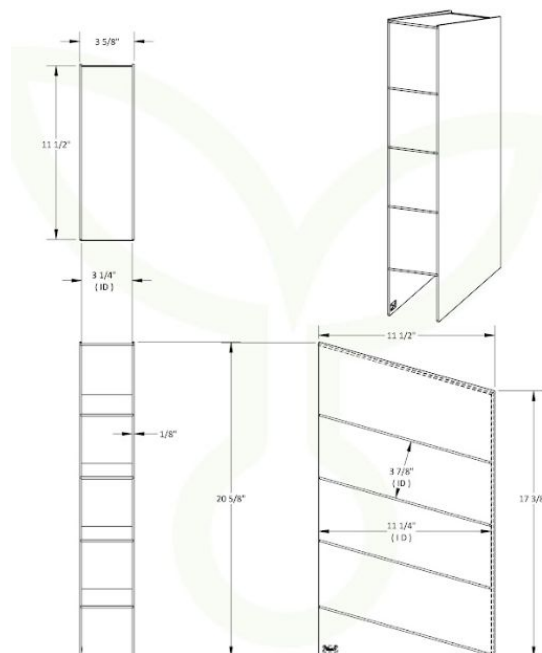

Corrosion Resistant



Short Lead Times



Ships Assembled



Made in the U.S.A



100% Lifetime Guarantee